



## Rustler Clipless Body Conversion Kit Installation

Covers Part #3734R

### Kit contents:

- Body mounts (front & rear)
- Front body mount spacer
- Support bracket (for Magnum 272R™ transmission)
- Support bracket (for 272 transmission)
- Upper chassis
- Front clipless latch
- Front latch mounts (left & right)
- Rear clipless latch

- 3x23mm button-head cap screws (BCS) (2)
- 3x10mm button-head cap screws (BCS) (6)
- 3x8mm button-head cap screws (BCS) (4)
- 2.5x10mm button-head cap screws (BCS) (4)

### Tools required:

- Tapered body reamer (part #3433 or #3433X)
- 2.5mm hex wrench
- 2.0mm hex wrench

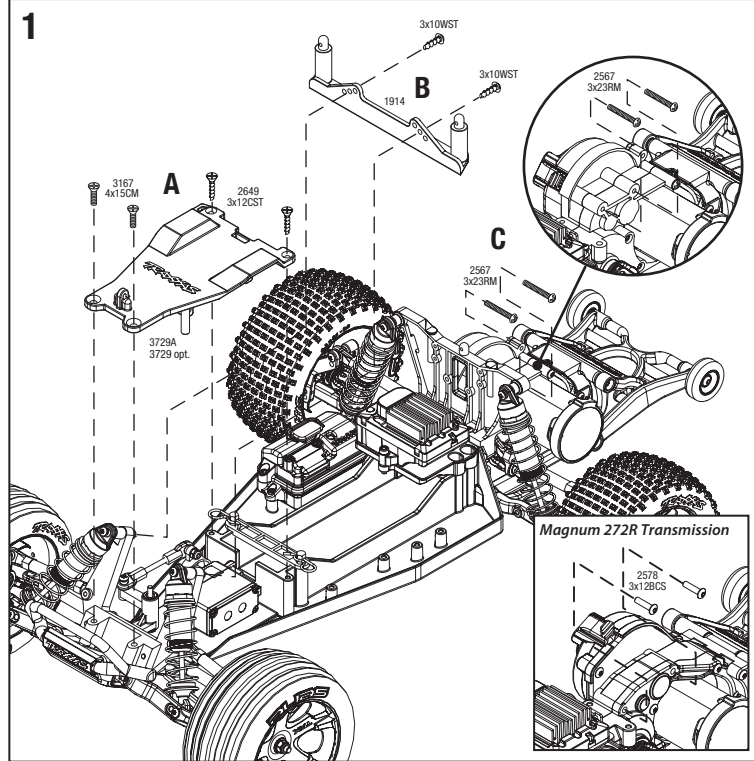

- 1A. Remove the existing upper chassis by removing the 3x12mm screws (2) and 4x15mm screws (2).
- 1B. Remove the existing front body mount from the shock towers by removing the 3x10mm screws (2).
- 1C. Remove the existing 3x23mm screws (2) from the transmission housing.

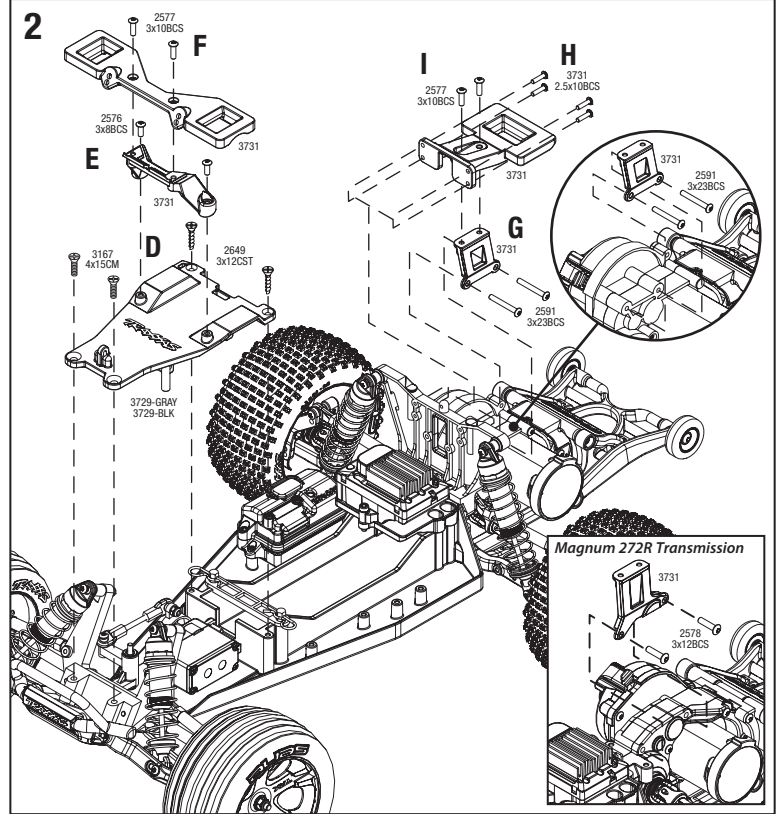

- 2D. Install the new upper chassis with the screws removed in step 1A.
- 2E. Install the included body mount spacer onto the upper chassis using the included 3x8mm BCS (4).
- 2F. Secure the front body mount to the spacer and upper chassis using the included 3x10mm BCS (2).
- 2G. Attach the rear body mount support bracket to the transmission housing using the included 3x23mm BCS (2).
- 2H. Install the rear body mount on the rear shock tower using the included 2.5x10mm BCS (4).
- 2I. Secure the rear body mount to the support bracket using the included 3x10mm BCS (2).

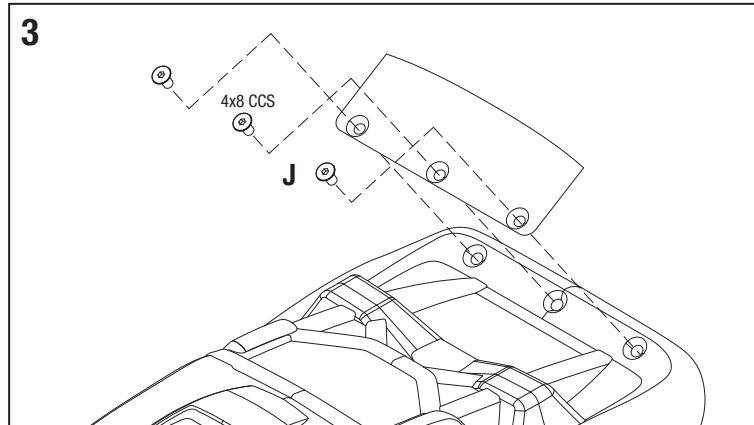

- 3J. Remove the 4x8mm CCS and plastic nuts (3) to remove the wing from the body.

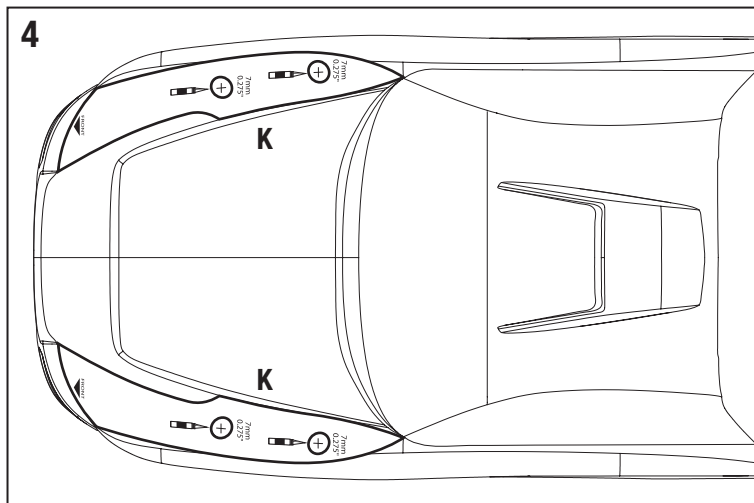

- 4K. Peel the backing from the included self-adhesive cutting templates. Install the templates on the vehicle body, aligning the edges with the existing body post holes and body lines. Using a tapered body reamer, carefully cut the holes in the truck body as shown on the templates for the screw bosses for the front and rear latch mounts (note the hole diameters indicated on the templates and the corresponding diameter measurements on the body reamer).

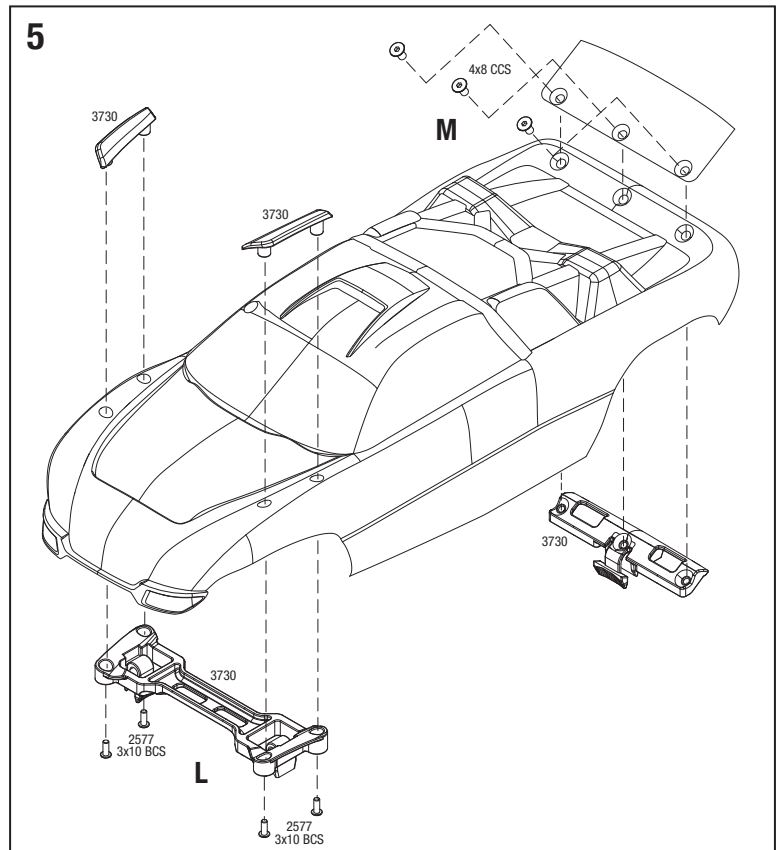
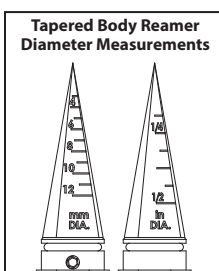

- 5L. Install the front clipless latch/latch mounts on the body. Use the included 3x10mm screws (4).
- 5M. Install the wing and the rear clipless latch on the body using the 4x8mm CCS (3) removed in step 3J.

**CAUTION: RISK OF INJURY!**  
Use care with hobby knives, tapered reamers, and other cutting tools as they are extremely sharp and can cause severe injury, deep cuts, and/or punctures.